

A photograph of a white electric vehicle (EV) parked at a black charging station. The car is on the right, with a charging cable plugged into its port. The charging station is on the left. In the background, there is a large, multi-story brick apartment building with many windows and balconies. The scene is outdoors with green grass and some trees.

EV Charger Commissioning Instructions

Wallbox

Wallbox

Tools Needed:

- Smart phone or device
- Wallbox App
- SWTCH Charger ID Labels

Step 1: Linking the chargers

- Create an account
- Link charger
- Transfer ownership (optional)
- Repeat for each charger

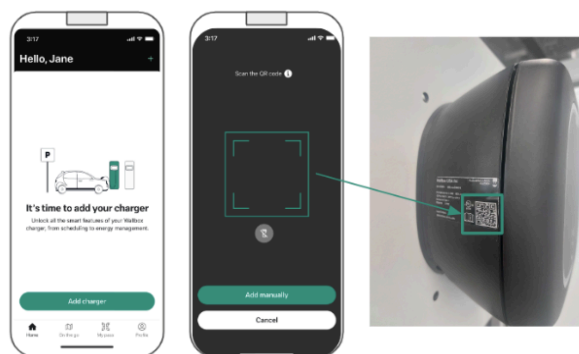

*Linking the chargers to an account is necessary to ensure ownership of the hardware is correctly assigned

*When transferring, ensure the property owner of the charger has a Wallbox account ready

Step 2: Configure the OCPP URL

- Using Wallbox App, configure OCPP settings
- OCPP URL: <ws://ocpp.swtchev.com/site-address>.
- For example: <ws://ocpp.swtchev.com/7-Queen-Elizabeth-Blvd>
- No postal or zip code
- Chargers located at the same site must have the exact same OCPP URL
- Repeat for each charger

Step 3: Configure the Wireless Network

- Using the Wallbox app, connect to charger via Bluetooth
- Configure to SWTCH wireless network
- Password: SWTCH456!
- Repeat for each charger

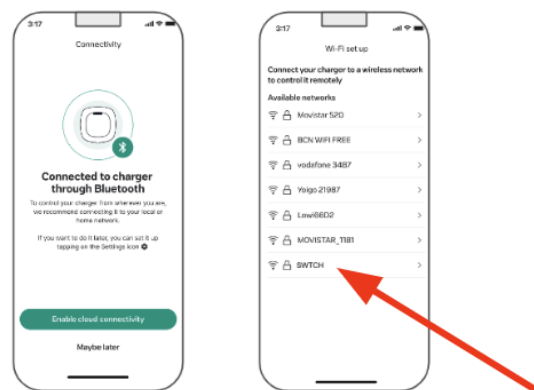

Step 4: Commission with SWTCH

- Place charger ID labels on the front of each charger
- Schedule on-site Commissioning Call
- Complete Final Commissioning Form
 - Please include the Charger ID and the associated Serial Number. This will allow our team to connect the charger to the specific site address.
- Attend on-site Commissioning Call
 - The SWTCH team will verify connectivity to the SWTCH network and run a test transaction